



User Manual

Read and understand this manual before using machine.

INDUSTRIAL TYPE II FENCE

Model 35672 (30-in.) shown



**Model Numbers
35672, 35676**

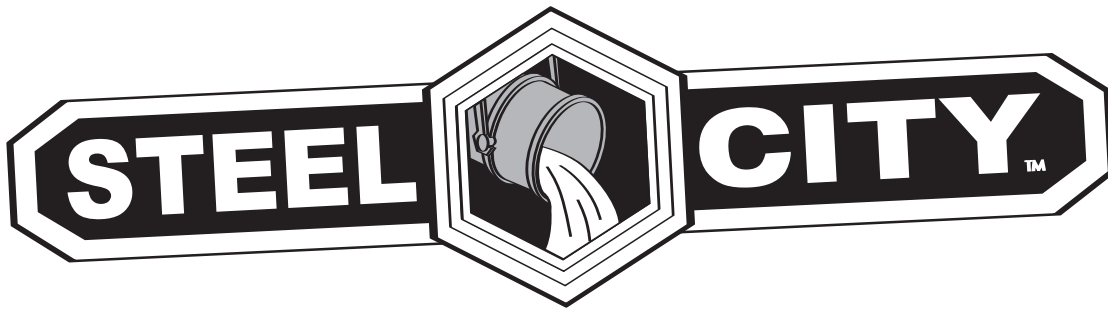

THANK YOU for purchasing your new Steel City Industrial Type II Fence. This fence has been designed, tested, and inspected with you, the customer, in mind. When properly assembled, used and maintained, your fence will provide you with years of trouble free service, which is why it is backed by one of the longest machinery warranties in the business.

This Industrial Type II Fence is just one of many products in the Steel City family of woodworking machinery and is proof of our commitment to total customer satisfaction.

At Steel City we continue to strive for excellence each and every day and value the opinion of you, our customer. For comments about your fence or Steel City Tool Works, please visit our web site at www.steelcitytoolworks.com .

TABLE OF CONTENTS

INTRODUCTION

SECTION 1	Warranty	4
SECTION 2	General Safety	7
SECTION 3	Product Safety	9
SECTION 4	Unpacking & Inventory	11
SECTION 5	Assembly	14
SECTION 6	Adjustments	18
SECTION 7	Parts List.....	21

INTRODUCTION

This user manual is intended for use by anyone working with this tool. It should be kept available for immediate reference so that all operations can be performed with maximum efficiency and safety. Do not attempt to perform maintenance or operate this tool until you have read and understand the information contained in this manual.

The drawings, illustrations, photographs, and specifications in this user manual represent your machine at time of print. However, changes may be made to your machine or this manual at any time with no obligation to Steel City Tool Works.

WARRANTY

STEEL CITY TOOL WORKS 5 YEAR LIMITED WARRANTY

Steel City Tool Works, LLC (“SCTW”) warrants all “STEEL CITY TOOL WORKS” machinery to be free of defects in workmanship and materials for a period of 5 years from the date of the original retail purchase by the original owner. (Granite components are warranted for 10 years. See the Granite warranty statement supplied with those products.) SCTW will repair or replace, at its expense and at its option, any SCTW machine, machine part, or machine accessory which in normal use has proven to be defective, provided that the customer returns the product, shipping prepaid, to an authorized service center with proof of purchase and provides SCTW with a reasonable opportunity to verify the alleged defect by inspection. This warranty does not apply to defects due directly or indirectly to misuse, abuse, negligence, accidents, or lack of maintenance, or to repairs or alterations made or specifically authorized by anyone other than SCTW. Normal wear components are also excluded under this coverage. Every effort has been made to ensure that all SCTW machinery meets the highest quality and durability standards. We reserve the right to change specifications at any time due to our commitment to continuous improvement of the quality of our products.

EXCEPT AS SET FORTH ABOVE, SCTW MAKES NO EXPRESS OR IMPLIED REPRESENTATIONS OR WARRANTIES WITH RESPECT TO ITS MACHINERY, OR ITS CONDITION, MERCHANTABILITY, OR FITNESS FOR ANY PARTICULAR PURPOSE OR USE. SCTW FURNISHES THE ABOVE WARRANTIES IN LIEU OF ALL OTHER WARRANTIES, EXPRESS OR IMPLIED, INCLUDING THE WARRANTIES OF MERCHANTABILITY AND FITNESS FOR A PARTICULAR PURPOSE, WHICH ARE HEREBY SPECIFICALLY DISCLAIMED.

SCTW SHALL NOT BE LIABLE FOR ANY (A) SPECIAL, INDIRECT, INCIDENTAL, PUNITIVE OR CONSEQUENTIAL DAMAGES, INCLUDING WITHOUT LIMITATION LOSS OF PROFITS, ARISING FROM OR RELATED TO THIS WARRANTY, THE BREACH OF ANY AGREEMENT OR WARRANTY, OR THE OPERATION OR USE OF ITS MACHINERY, INCLUDING WITHOUT LIMITATION DAMAGES ARISING FROM DAMAGE TO FIXTURES, TOOLS, EQUIPMENT, PARTS OR MATERIALS, DIRECT OR INDIRECT LOSS CAUSED BY ANY OTHER PARTY, LOSS OF REVENUE OR PROFITS, FINANCING OR INTEREST CHARGES, AND CLAIMS BY ANY THIRD PERSON, WHETHER OR NOT NOTICE OF SUCH POSSIBLE DAMAGES HAS BEEN GIVEN TO SCTW; (B) DAMAGES OF ANY KIND FOR ANY DELAY BY OR FAILURE OF SCTW TO PERFORM ITS OBLIGATIONS UNDER THIS AGREEMENT; OR (C) CLAIMS MADE A SUBJECT OF A LEGAL PROCEEDING AGAINST SCTW MORE THAN ONE (1) YEAR AFTER SUCH CAUSE OF ACTION FIRST AROSE.

The validity, construction and performance of this Warranty and any sale of machinery by SCTW shall be governed by the laws of the Commonwealth of Pennsylvania, without regard to conflicts of laws provisions of any jurisdiction. Any action related in any way to any alleged or actual offer, acceptance or sale by SCTW, or any claim related to the performance of any agreement including without limitation this Warranty, shall take place in the federal or state courts in Allegheny County, Pennsylvania.

WARRANTY CARD

Name _____
 Street _____
 Apt. No. _____
 City _____ State _____ Zip _____
 Phone Number _____
 E-Mail _____

Product Description: _____
 Model No.: _____
 Serial No. _____

The following information is given on a voluntary basis and is strictly confidential.

1. Where did you purchase your STEEL CITY machine?
 Store: _____
 City: _____

2. How did you first learn of Steel City Tool Works?
 Advertisement Mail Order Catalog
 Web Site Friend
 Local Store Other _____

3. Which of the following magazines do you subscribe to?
 American Woodworker American How-To
 Cabinetmaker Family Handyman
 Fine Homebuilding Fine Woodworking
 Journal of Light Construction Old House Journal
 Popular Mechanics Popular Science
 Popular Woodworking Today's Homeowner
 WOOD Woodcraft
 WOODEN Boat Woodshop News
 Woodsmith Woodwork
 Woodworker Woodworker's Journal
 Workbench Other _____

4. Which of the following woodworking / remodeling shows do you watch?
 Backyard America The American Woodworker
 Home Time The New Yankee Workshop
 This Old House Woodwright's Shop
 Other _____

5. What is your annual household income?
 \$20,000 to \$29,999 \$30,000 to \$39,999
 \$40,000 to \$49,999 \$50,000 to \$59,999
 \$60,000 to \$69,999 70,000 to \$79,999
 \$80,000 to \$89,999 \$90,000 +

6. What is your age group?
 20 to 29 years 30 to 39 years
 40 to 49 years 50 to 59 years
 60 to 69 years 70 + years

7. How long have you been a woodworker?
 0 to 2 years 2 to 8 years
 8 to 20 years over 20 years

8. How would you rank your woodworking skills?
 Simple Intermediate
 Advance Master Craftsman

9. How many Steel City machines do you own? _____

10. What stationary woodworking tools do you own?
Check all that apply.
 Air Compressor Band Saw
 Drill Press Drum Sander
 Dust Collection Horizontal Boring Machine
 Jointer Lathe
 Mortiser Panel Saw
 Planer Power Feeder
 Radial Arm Saw Shaper
 Spindle Sander Table Saw
 Vacuum Veneer Press Wide Belt Sander
 Other _____

11. Which benchtop tools do you own? *Check all that apply.*
 Belt Sander Belt / Disc Sander
 Drill Press Band Saw
 Grinder Mini Jointer
 Mini Lathe Scroll Saw
 Spindle / Belt Sander Other _____

12. Which portable / hand held power tools do you own?
Check all that apply.
 Belt Sander Biscuit Jointer
 Dust Collector Circular Saw
 Detail Sander Drill / Driver
 Miter Saw Orbital Sander
 Palm Sander Portable Thickness Planer
 Saber Saw Reciprocating Saw
 Router Other _____

13. What machines / accessories would you like to see added to the STEEL CITY line?

14. What new accessories would you like to see added?

15. Do you think your purchase represents good value?
 Yes No

16. Would you recommend STEEL CITY products to a friend?
 Yes No

17. Comments:

CUT HERE

FOLD ON DOTTED LINE

PLACE
STAMP
HERE

**Steel City Tool Works
201 Ann St., Suite 200
Oakmont, PA 15139**

FOLD ON DOTTED LINE

GENERAL SAFETY

⚠ WARNING

TO AVOID serious injury and damage to the machine, read and follow all Safety and Operating Instructions before assembling and operating this machine.

This manual is not totally comprehensive. It does not and can not convey every possible safety and operational problem which may arise while using this machine. The manual will cover many of the basic and specific safety procedures needed in an industrial environment.

All federal and state laws and any regulations having jurisdiction covering the safety requirements for use of this machine take precedence over the statements in this manual. Users of this machine must adhere to all such regulations.

Below is a list of symbols that are used to attract your attention to possible dangerous conditions.



This is the international safety alert symbol. It is used to alert you to potential personal injury hazards. Obey all safety messages that follow this symbol to avoid possible injury or death.

⚠ DANGER

Indicates an imminently hazardous situation which, if not avoided, **WILL** result in death or serious injury.

⚠ WARNING

Indicates a potentially hazardous situation which, if not avoided, **COULD** result in death or serious injury.

⚠ CAUTION

Indicates a potentially hazardous situation, if not avoided, **MAY** result in minor or moderate injury. It may also be used to alert against unsafe practices.

CAUTION

CAUTION used without the safety alert symbol indicates a potentially hazardous situation which, if not avoided, may result in property damage.

NOTICE

This symbol is used to alert the user to useful information about proper operation of the machine.

⚠ WARNING

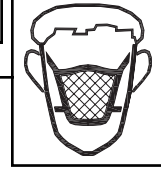

Exposure to the dust created by power sanding, sawing, grinding, drilling and other construction activities may cause serious and permanent respiratory or other injury, including silicosis (a serious lung disease), cancer, and death. Avoid breathing the dust, and avoid prolonged contact with dust. The dust may contain chemicals known to the State of California to cause cancer, birth defects or other reproductive harm.

Some examples of these chemicals are:

- Lead from lead-based paints.
- Crystalline silica from bricks, cement and other masonry products.
- Arsenic and chromium from chemically-treated lumber.

Always operate tool in well ventilated area and provide for proper dust removal. Use a dust collection system along with an air filtration system whenever possible. Always use properly fitting NIOSH/OSHA approved respiratory protection appropriate for the dust exposure, and wash exposed areas with soap and water.

1. To avoid serious injury and damage to the machine, read the entire User Manual before assembly and operation of this machine.

⚠ WARNING

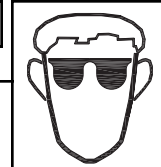

2. **ALWAYS** wear eye protection. Any machine can throw debris into the eyes during operations, which could cause severe and permanent eye damage. Everyday eyeglasses are **NOT** safety glasses. **ALWAYS** wear Safety Goggles (that comply with ANSI standard Z87.1) when operating power tools.

⚠ WARNING

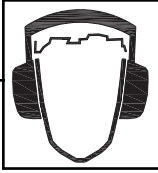

3. **ALWAYS** wear hearing protection. Plain cotton is not an acceptable protective device. Hearing equipment should comply with ANSI S3.19 Standards.

⚠ WARNING

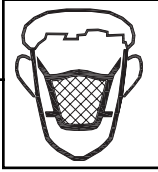

4. **ALWAYS** wear a NIOSH/OSHA approved dust mask to prevent inhaling dangerous dust or airborne particles.

5. **ALWAYS** keep the work area clean, well lit, and organized. **DO NOT** work in an area that has slippery floor surfaces from debris, grease, and wax.
6. **ALWAYS** unplug the machine from the electrical receptacle before making adjustments, changing parts or performing any maintenance.
7. **AVOID ACCIDENTAL STARTING.** Make sure that the power switch is in the "OFF" position before plugging in the power cord to the electrical receptacle.

⚠ WARNING

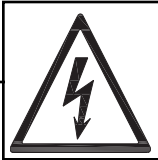

8. **AVOID** a dangerous working environment. **DO NOT** use electrical tools in a damp environment or expose them to rain or moisture.

⚠ WARNING



9. **CHILDPROOF THE WORKSHOP AREA** by removing switch keys, unplugging tools from the electrical receptacles, and using padlocks.

10. **DO NOT** use electrical tools in the presence of flammable liquids or gasses.

11. **DO NOT FORCE** the machine to perform an operation for which it was not designed. It will do a safer and higher quality job by only performing operations for which the machine was intended.
12. **DO NOT** stand on a machine. Serious injury could result if it tips over or you accidentally contact any moving part.
13. **DO NOT** store anything above or near the machine.
14. **DO NOT** operate any machine or tool if under the influence of drugs, alcohol, or medication.
15. **EACH AND EVERY** time, check for damaged parts prior to using any machine. Carefully check all guards to see that they operate properly, are not damaged, and perform their intended functions. Check for alignment, binding or breakage of all moving parts. Any guard or other part that is damaged should be immediately repaired or replaced.
16. Ground all machines. If any machine is supplied with a 3-prong plug, it must be plugged into a 3-contact electrical receptacle. The third prong is used to ground the tool and provide protection against accidental electric shock. **DO NOT** remove the third prong.
17. Keep visitors and children away from any machine. **DO NOT** permit people to be in the immediate work area, especially when the machine is operating.
18. **KEEP** protective guards in place and in working order.
19. **MAINTAIN** your balance. **DO NOT** extend yourself over the tool. Wear oil resistant rubber soled shoes. Keep floor clear of debris, grease, and wax.
20. **MAINTAIN** all machines with care. **ALWAYS KEEP** machine clean and in good working order. **KEEP** all blades and tool bits sharp.
21. **NEVER** leave a machine running, unattended. Turn the power switch to the OFF position. **DO NOT** leave the machine until it has come to a complete stop.
22. **REMOVE ALL MAINTENANCE TOOLS** from the immediate area prior to turning the machine ON.
23. **SECURE** all work. When it is possible, use clamps or jigs to secure the workpiece. This is safer than attempting to hold the workpiece with your hands.
24. **STAY ALERT**, watch what you are doing, and use common sense when operating any machine. **DO NOT** operate any machine tool while tired or under the influence of drugs, alcohol, or medication. A moment of inattention while operating power tools may result in serious personal injury.

25. **USE ONLY** recommended accessories. Use of incorrect or improper accessories could cause serious injury to the operator and cause damage to the machine. If in doubt, **DO NOT** use it.
26. Wear proper clothing, **DO NOT** wear loose clothing, gloves, neckties, or jewelry. These items can get caught in the machine during operations and pull the operator into the moving parts. Users must wear a protective cover on their hair, if the hair is long, to prevent it from contacting any moving parts.
27. **SAVE** these instructions and refer to them frequently and use them to instruct other users.

28. Information regarding the safe and proper operation of this tool is also available from the following sources:

Power Tool Institute
 1300 Summer Avenue
 Cleveland, OH 44115-2851
www.powertoolinstitute.org

National Safety Council
 1121 Spring Lake Drive
 Itasca, IL 60143-3201

American National Standards Institute
 25 West 43rd. St, 4th Floor
 New York, NY. 10036
 ANSI 01.1 Safety Requirements
 For Woodworking Machines
WWW.ANSI.ORG

U.S. Department of Labor Regulations
 OSHA 1910.213 Regulations
WWW.OSHA.GOV

PRODUCT SAFETY

1. Serious personal injury may occur if normal safety precautions are overlooked or ignored. Accidents are frequently caused by lack of familiarity or failure to pay attention. Obtain advice from supervisor, instructor, or another qualified individual who is familiar with this tool and its operations.
2. Every work area is different. Always consider safety first, as it applies to your work area. Use this tool with respect and caution. Failure to do so could result in serious personal injury and damage to the machine.
3. Prevent electrical shock. Follow all electrical and safety codes, including the National Electrical Code (NEC) and the Occupational Safety and Health Regulations (OSHA). All electrical connections and wiring should be made by qualified personnel only.

5. **STOP** using this tool, if at any time you experience difficulties in performing any operation. Contact your supervisor, instructor or machine service center immediately.
6. Safety decals are on this tool to warn and direct you to how to protect yourself or visitors from personal injury. These decals **MUST** be maintained so that they are legible. **REPLACE** decals that are not legible.
7. **DO NOT** leave the unit plugged into the electrical outlet. Unplug the unit from the outlet when not in use and before servicing, performing maintenance tasks, or cleaning.
8. **ALWAYS** turn the power switch "OFF" before unplugging the table saw.

⚠ WARNING

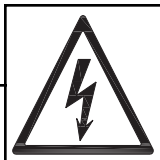

4. **TO REDUCE** the risk of electrical shock. **DO NOT** use this machine outdoors. **DO NOT** expose to rain or moisture. Store indoors in a dry area.

⚠ WARNING

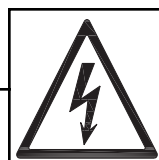

9. **DO NOT** handle the plug or table saw with wet hands.

10. **USE** accessories only recommended by Steel City.
11. **DO NOT** pull the table saw by the power cord. **NEVER** allow the power cord to come in contact with sharp edges, hot surfaces, oil or grease.
12. **DO NOT** unplug the table saw by pulling on the power cord. **ALWAYS** grasp the plug, not the cord.
13. **REPLACE** a damaged cord immediately. **DO NOT** use a damaged cord or plug. If the table saw is not operating properly, or has been damaged, left outdoors or has been in contact with water.
14. **DO NOT** use the table saw as a toy. **DO NOT** use near or around children.
15. **ENSURE** that the machine sits firmly on the floor before using. If the machine wobbles or is unstable, correct the problem by using shims or blocks prior to operation.
16. **KEEP** saw blade sharp and clean. Failure to do so greatly increases friction, decreases cut quality, and increases the possibility of a kickback
17. **MAKE CERTAIN** the saw blade is parallel with the miter slots and with the rip fence. A blade that is not aligned parallel can cause the workpiece to be pinched between the blade and the fence causing burning or kickbacks.
18. **ALWAYS** use blade guard on all through cuts. This will help prevent the cut from closing on the back of the saw blade. The blade guard also has anti-kickback fingers which minimize the chance of a workpiece being thrown back during a cutting operation.
19. **ALWAYS** push the workpiece past the blade. **DO NOT** release a workpiece until it is past the blade and removed from the saw.
20. **DO NOT** execute a cut when you do not have complete control of the situation
21. **DO NOT** cut a workpiece that is too large for you to handle.
22. **DO NOT** use the rip fence as a guide when cross-cutting
23. **BE MINDFUL** of flaws in the wood. Cutting a warped or twisted board along the rip fence can get pinched between the fence and the blade, causing a kickback
24. **ALWAYS** remove cut off pieces and scraps from the table before starting the saw
25. **NEVER** start the machine with the workpiece against the blade
26. **NEVER** perform freehand operations. Use either the fence or miter gauge to position and guide the workpiece through the blade.
27. **ALWAYS** use a pushstick for ripping narrow workpieces
28. **NEVER** have any part of your body in line with the path of the saw blade. If a kickback occurs with you directly in front of the blade, a serious injury can occur.
29. **NEVER** attempt to free a stalled blade without first turning the machine off and disconnecting the saw from the power source.

UNPACKING & INVENTORY

Check shipping carton for damage before unpackaging. Carefully remove packaging materials and parts from shipping carton. Always check for and remove protective shipping materials around moving parts. Lay out all parts on a clean work surface.

Remove any protective materials and coatings from all of the parts. The protective coatings can be removed

by spraying WD-40 on them and wiping it off with a soft cloth. This may need redone several times before all of the protective coatings are removed completely.

Compare the items to inventory figures; verify that all items are accounted for before discarding the shipping box. **For missing parts, contact Steel City at 1-877-SC4-TOOL.**

Fig. 1

RAILS AND FENCE ASSEMBLY

- A. Rear Rail
- B. Guide Tube
- C. Front Rail
- D. Fence Assembly

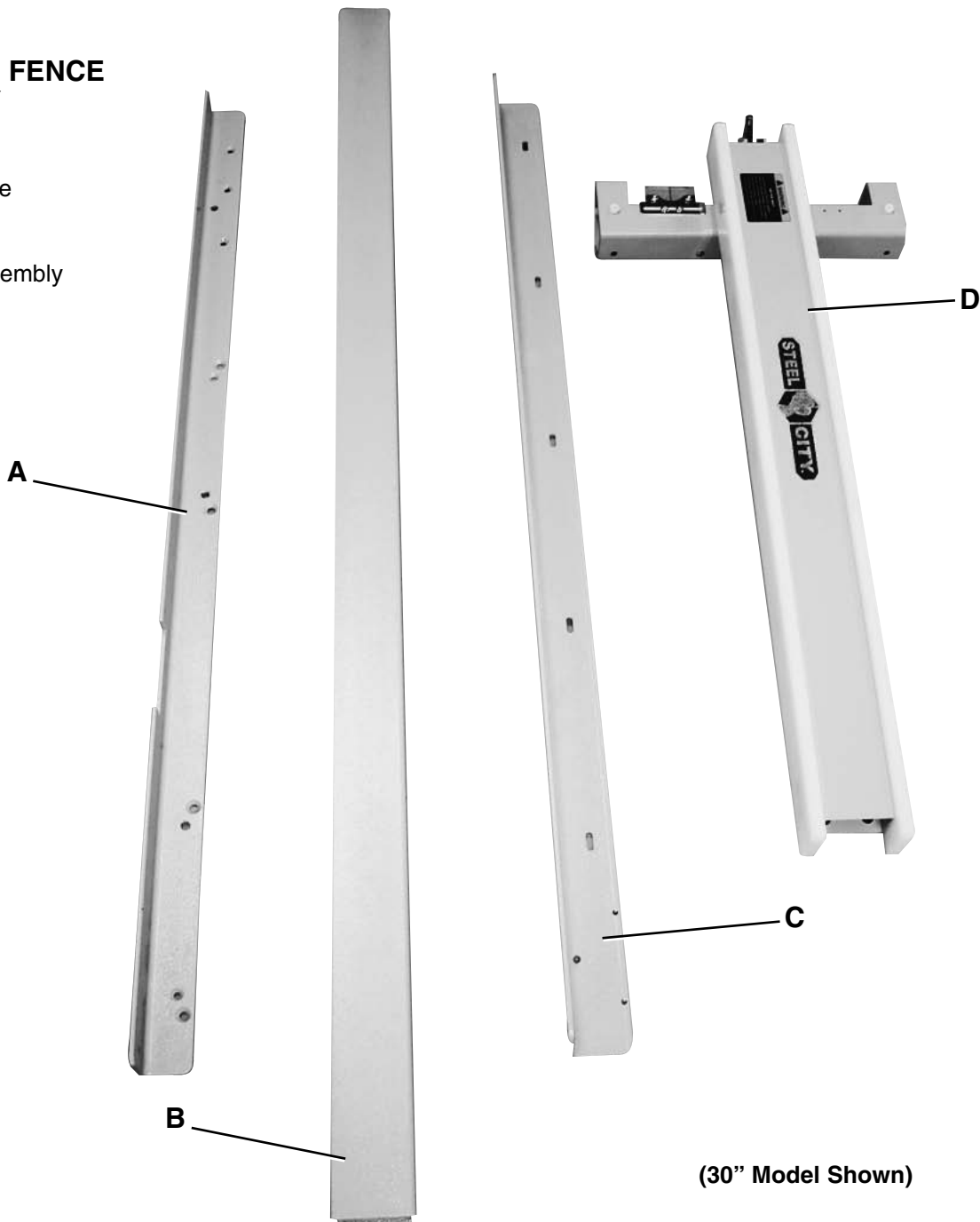

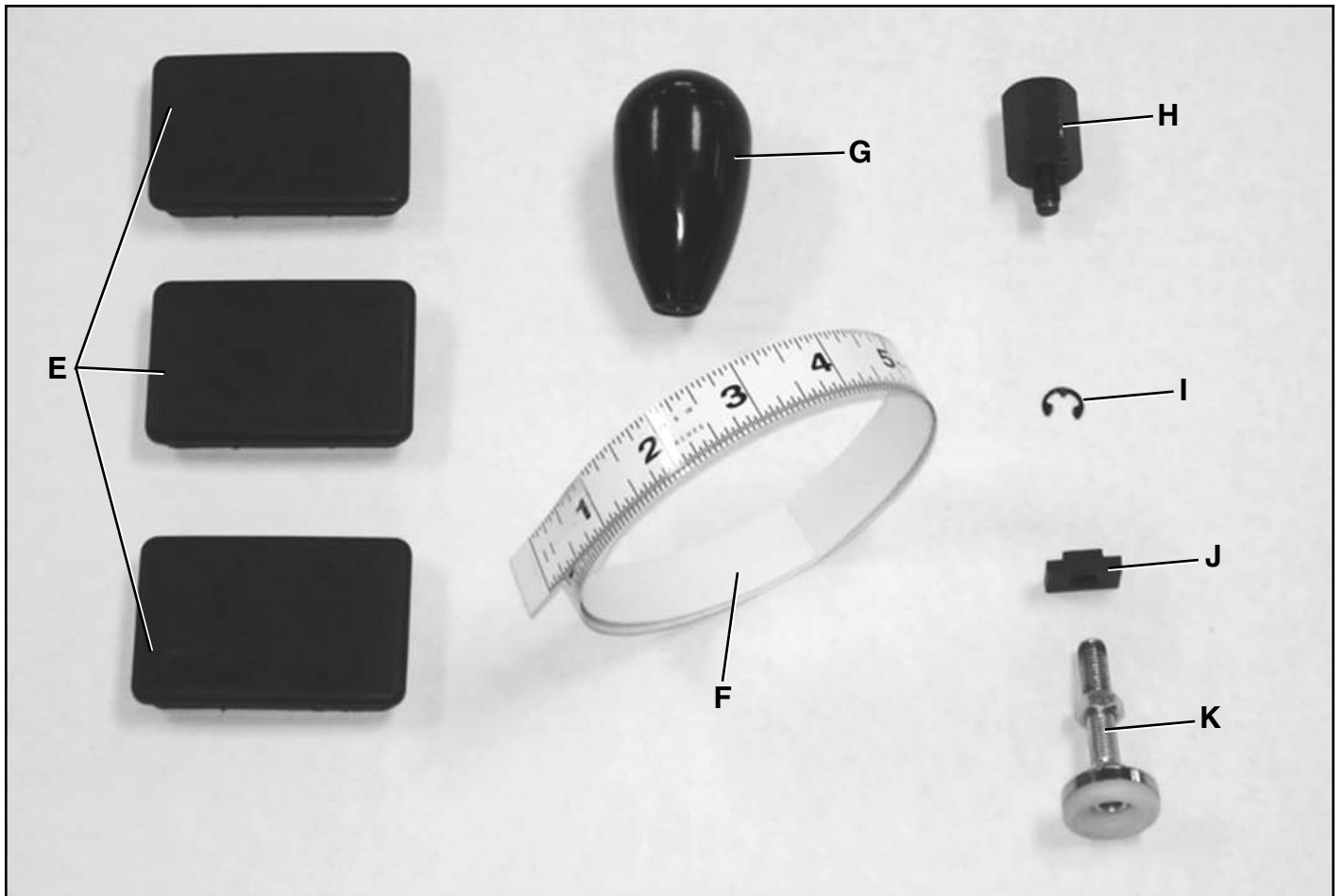

Fig. 2

FENCE AND RAIL COMPONENTS

- E. Plastic Endcaps(3)
- F. Scale
- G. Fence Locking Knob
- H. Block Screw
- I. E Clip
- J. M8 Special Square Nut
- K. Fence Foot Assembly

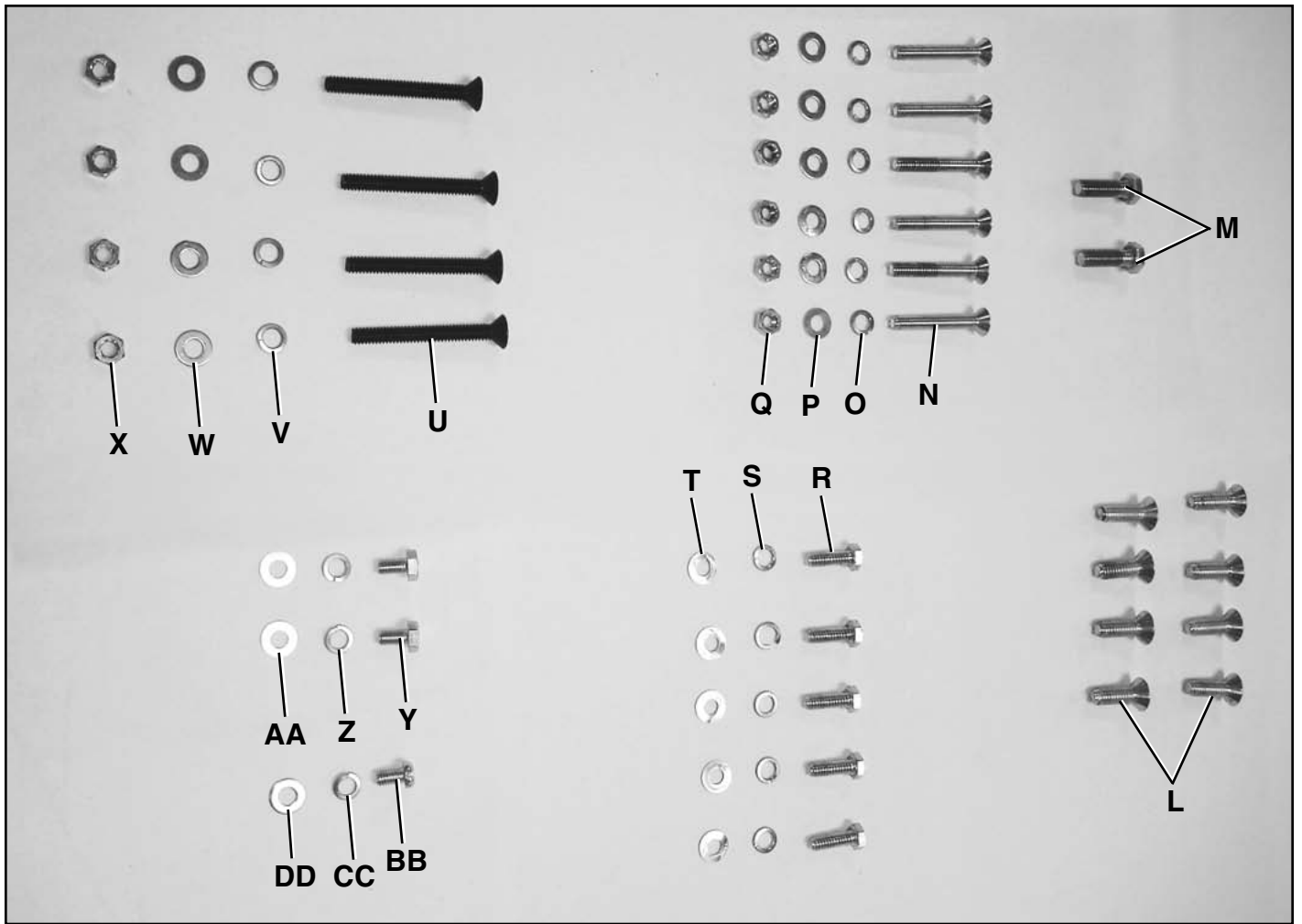

Fig. 3

HARDWARE

The hardware listed below is used for mounting the rails to GRANITE TABLETOPS ONLY

- L. 5/16-18 x 1" Hex Socket Flat Head Screw (8)

The hardware listed below is used for mounting the rails to CAST IRON TABLETOPS ONLY

- M. 5/16-18 x 1" Hex Head Screw (2)
- N. 1/4-20 x 1-3/4" Hex Socket Flat Head Screw (6)
- O. 1/4" Lock Washer (6)
- P. 1/4" Flat Washer (2)
- Q. 1/4" Hex Nut (6)

The following hardware is used with ALL TABLETOP STYLES

Guide Tube Hardware	30" Model	50" Model
R. 1/4-20 x 3/4" Hex Head Screw (30" - 5)	(5)	(7)
S. 1/4" Lock Washer	(5)	(7)
T. 1/4" Flat Washer	(5)	(7)

Table Board Hardware	30" Model	50" Model
U. 1/4-20 x 2-1/4" Hex Socket Flat Head Screw	(4)	(6)
V. 1/4" Lock Washer	(4)	(6)
W. 1/4" Flat Washer	(4)	(6)
X. 1/4" Hex Nut	(4)	(6)

Switch Mounting Hardware

- Y. M6 x 1 x 10mm Hex Head Screw (2)
- Z. M6 Lock Washer (2)
- AA. M6 Flat Washer (2)
- BB. M6 x 1 x 10mm Round Head Screw
- CC. M6 Lock Washer
- DD. M6 Flat Washer

Not Shown

- Wood Screws, 50" Model only (8)
- Nylon Set Screws (2)

ASSEMBLY

NOTICE: This Fence Assembly is designed to fit all of the Steel City brand table saws. There are different instructions and different hardware used for mounting the Front and Rear Rails depending on which type of tabletop is on your table saw. Be sure to follow the correct assembly instructions for your style table saw.

FRONT RAIL ASSEMBLY

When mounting the Front Rail to a granite table top, the upper row of holes (A) will be used. When mounting to a cast iron tabletop, the lower row of holes (B) will be used. **SEE FIG. 4.**

Fig. 4

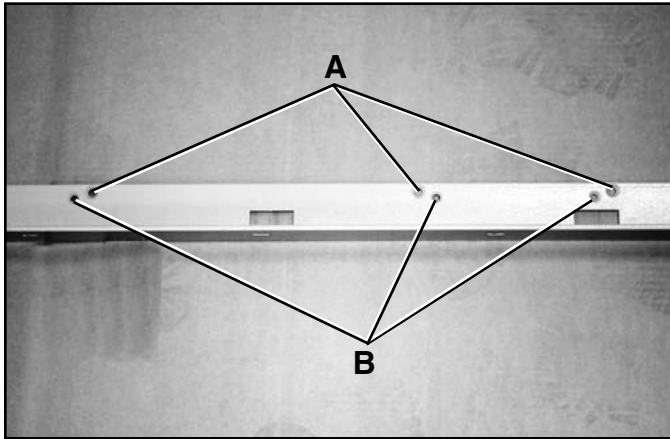

For Granite Tables ONLY

1. Fasten the Front Rail (A) to the table top using three 5/16-18 x 1" Hex Socket Flat Head Screws (B). **SEE FIG. 5.**

Fig. 5

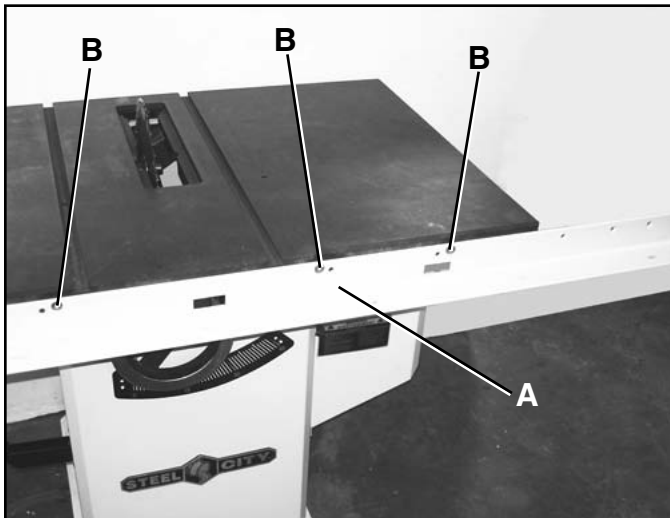

2. Fasten the Front Rail to the left extension wing using one 5/16-18 x 1" Hex Socket Flat head Screw.

For Cast Iron Tables ONLY

1. Fasten the Front Rail (A) to the table top using two 1/4-20 x 1-3/4" Hex Socket Flat Head Screws (B), two 1/4" Flat Washers, two 1/4" Lock Washers, and two 1/4" Hex Nuts. Tighten just enough to hold the rail next to the table, but keep loose enough to allow height adjustment. **DO NOT** attach the front rail to wings at this time. **SEE FIG. 5A.**

Fig. 5A

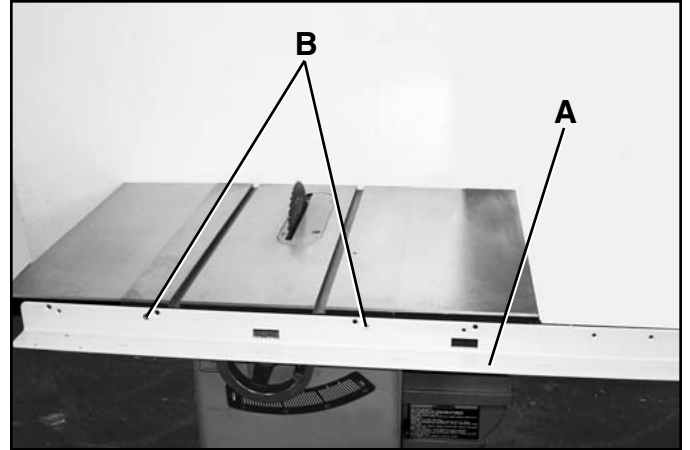

2. Using a combination square (C) on the table, adjust the front rail so that the rail is about 9/16" below the table surface. Check several locations along the table top to make sure that the front rail is parallel to the table top. **SEE FIG. 5B.**

Fig. 5B

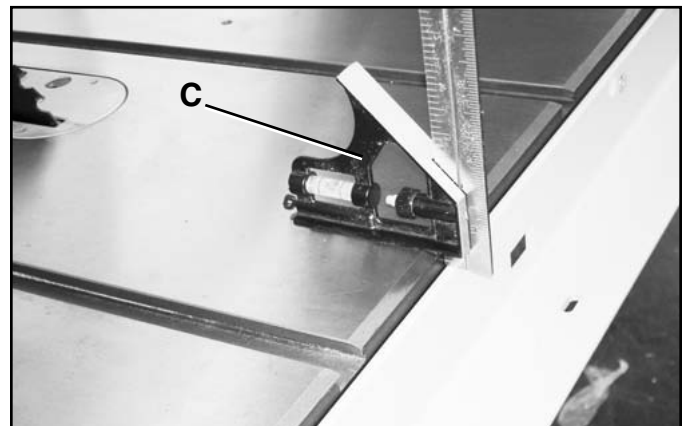

NOTICE: It is more important to have the front rail parallel to the table top than to be exactly 9/16" below the tabletop. The final measurement from the tabletop to the top of the rail can vary from 1/2" to 5/8" below the table surface.

3. Once the Front Rail is parallel to the table top, tighten both Screws installed in step 1.
4. Attach the Front Rail to each of the two extension wings using one 1/4-20 x 1-3/4" Hex Socket Flat Head Screw, one 1/4" Lock Washer, one 1/4" Flat Washer, and one 1/4" Hex Nut for each wing.

REAR RAIL ASSEMBLY

NOTICE: Just like on the Front Rail, when mounting the Rear Rail to a granite table top, the upper row of holes on the rail will be used. When mounting to a cast iron tabletop, the lower row of holes on the rail will be used.

For Granite Tables ONLY

1. Fasten the Rear Rail (A) to the table using three 5/16-18 x 1" Hex Socket Flat Head Screw (B). **SEE FIG. 6.**

Fig. 6

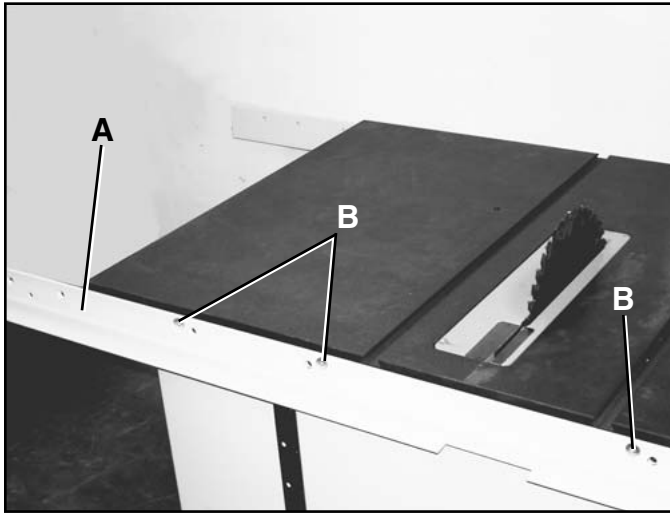

2. Fasten the Rear Rail to the left extension wing using one 5/16-18 x 1" Hex Socket Flat head Screw.

For Cast Iron Tables ONLY

1. Fasten the Rear Rail (A) to the table using two 5/16-18 x 1" Hex Head Screws (B). **SEE FIG. 6A.**

Fig. 6A

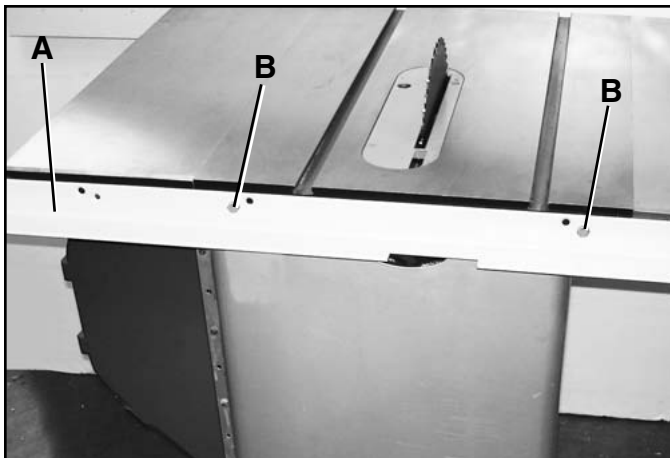

2. Fasten the Rear Rail to the each extension wing using one 1/4-20 x 1-3/4" Hex Socket Flat Head Screw, one 1/4" Flat Washer, one 1/4" Lock Washer, and one 1/4" Hex Nut for each extension wing.

TABLE BOARD ASSEMBLY

NOTICE: Only the 50" Fence System (Model #35676) comes equipped with a leg set. Owners of the 30" Fence System (Model #35672) can skip down to step 4 of this section.

NOTICE: The following set up assumes that the leg supports for the Table Board will be positioned on the floor. If you plan to attach the saw and Table Board to a mobile base, **MAKE CERTAIN** to fasten the legs to the table board in such a way that the legs match up with and will fit on the mobile base.

1. Place the Table Board upside down on the top of the table saw.
2. Place a leg assembly (A) into each outboard corner of the Table Board. **SEE FIG. 7.**

Fig. 7

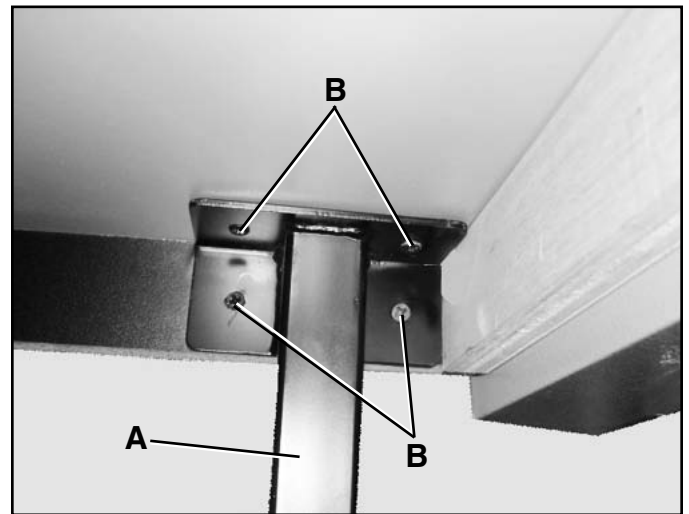

3. Attach each leg assembly using four wood screws (B)
4. Carefully turn the Table Board over and place in between the Front and Rear Rails. Use C-Clamps (not included) to hold the table in place if necessary.
5. Place a straight edge across the table saw and Table Board and level the table board with the saw table. Owners of the 50" Fence System (Model #35676) should raise or lower the adjustable feet on the leg assemblies to help ensure the Table Board is level with the saw table.

6. With the Table Board level with the saw table and secured in place using C-clamps, use the existing holes in the Front and Rear Rails as a guide and drill through the Table Board using either a 17/64" or 9/32" drill bit. **SEE FIG. 8.**

Fig. 8

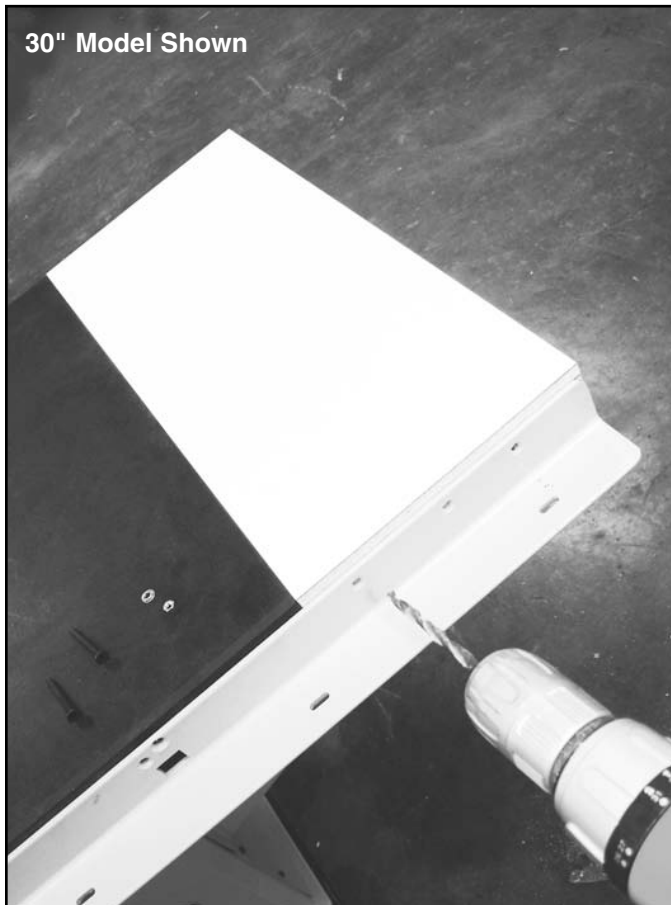

7. Fasten the Table Board in place using one 1/4-20 x 2-1/4" Hex Socket Flat Head Screw, one 1/4" Flat Washer, one 1/4" Lock Washer, and one 1/4" hex nut for each hole drilled in step 6.

ATTACHING REAR FOOT ASSEMBLY

1. Insert the threaded end of the Block Screw (B) through the Fence and thread into the M8 Special Square Nut (A). **SEE FIG. 9.**

Fig. 9

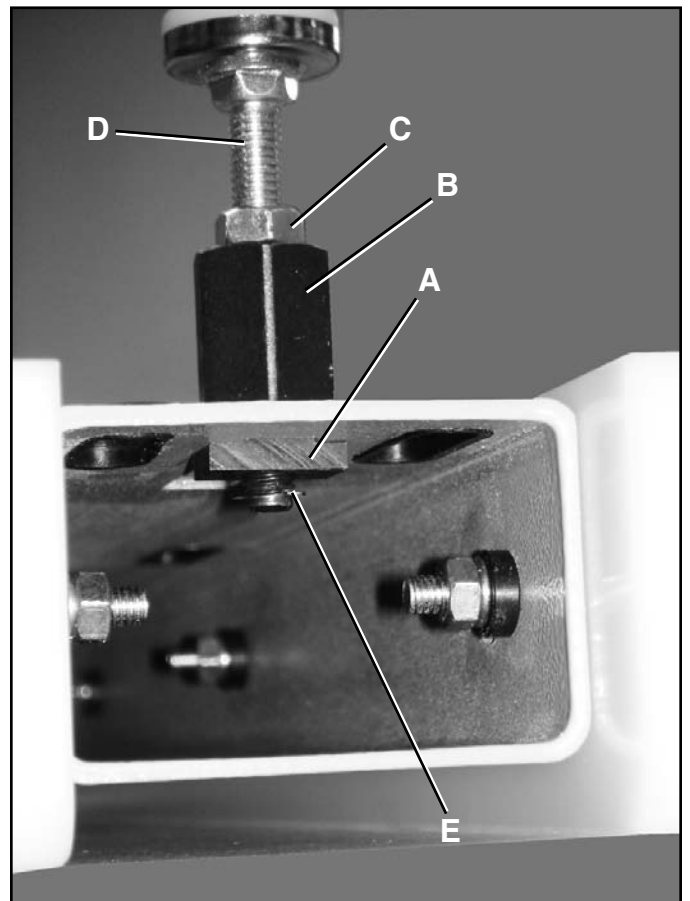

2. Fasten the E Clip (E) onto the threaded portion of the shaft
3. Thread the Foot Assembly (D) into the Block Screw. The Hex Nut (C) is used to lock the Foot Assembly at a certain level. This leveling procedure will be covered in the ADJUSTMENTS section of this manual.

NOTICE: Do not install the Plastic Endcap into the end of the Fence Assembly until **AFTER** adjusting the foot assembly.

ATTACHING THE GUIDE TUBE AND SCALE

1. Place the Guide Tube (A) on the Front Rail (B).
SEE FIG. 10.

Fig. 10

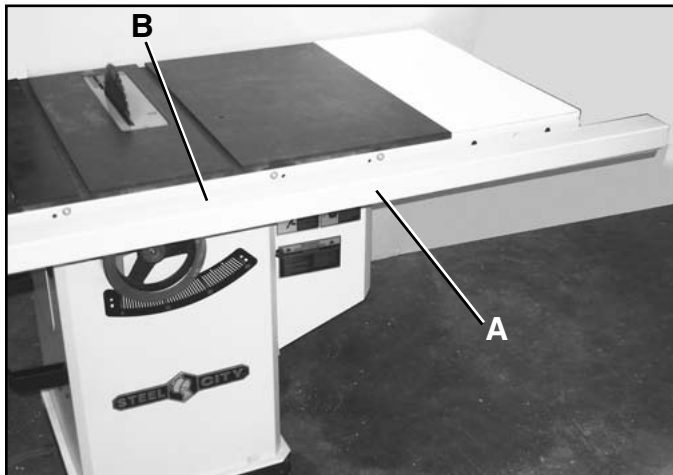

2. The Guide Tube must be fastened to the Front Rail using 1/4-20 x 3/4" Hex Head Screws (C), 1/4" Flat Washers, and 1/4" Lock Washers. If installing the Guide Tube on the 30" Model, five Screws, Flat Washers, and Lock Washers will be used to fasten the Guide Tube to the Front Rail. Installation of the 50" model will require seven Screws, Flat Washers, and Lock Washers. SEE FIG. 10A.

Fig. 10A

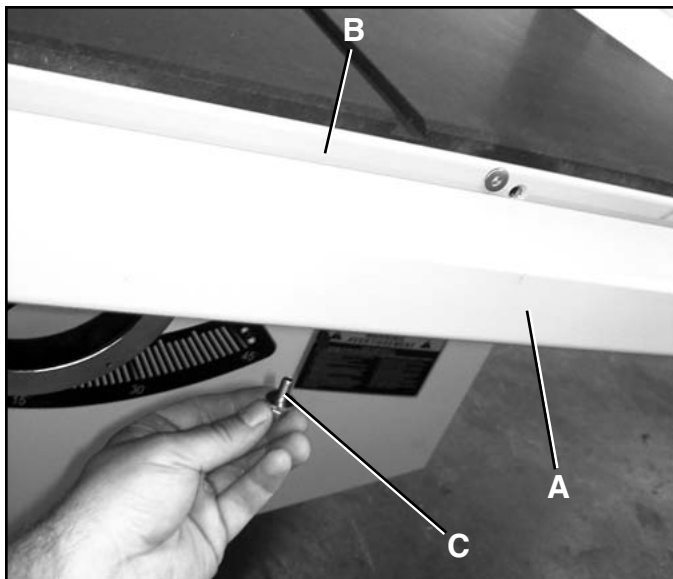

NOTICE: When Fastening the Guide Tube to the Front Rail you will notice that the Guide Tube has some range of movement left to right. Slide the Guide Tube on the Front Rail as far to the right as it will go before securely tightening the hardware.

3. Thread the Fence Locking Knob (G) onto the Fence Locking Handle. Place the Fence Body (D) on the table top with the left edge of the Fence up against the saw blade (E) and lock the fence down.
SEE FIG. 11.

Fig. 11

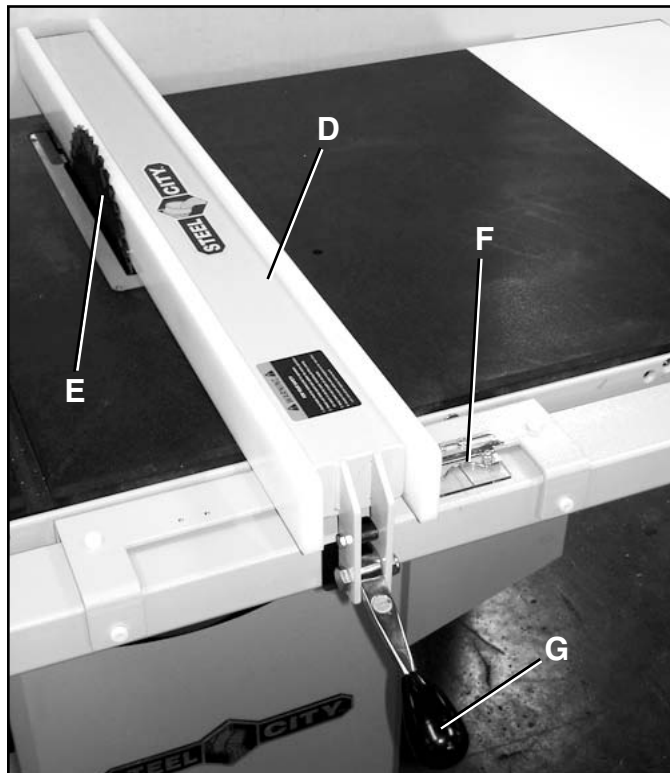

4. Using a pencil, make a mark on the Guide Tube where the red line on the Cursor (F) is. This will be your "zero" mark.
5. Remove the fence, peel the adhesive backing off the scale, and affix the scale to the Guide Tube about 1/4" from the front edge of the Guide Tube. Make sure to align the "0" on the scale with the "zero" mark you made in the previous step.
SEE FIG. 12.

Fig. 12



6. Insert one black Plastic Endcap into each end of the Guide Tube

ATTACHING THE SWITCH

Some Steel City Table Saws require that the Switch Assembly be mounted to the bottom of the Front Rail. If this is the case with your saw, the holes are predrilled in the Front Rail and hardware is provided with this Fence Kit.

ADJUSTMENTS

NOTICE: Fence Adjustments should be performed in the order listed in this manual

ADJUSTING THE REAR FOOT ASSEMBLY

1. Make sure that the Rear Foot Assembly (A) rests on the Rear Rail (B) as shown. **SEE FIG. 13.**

Fig. 13

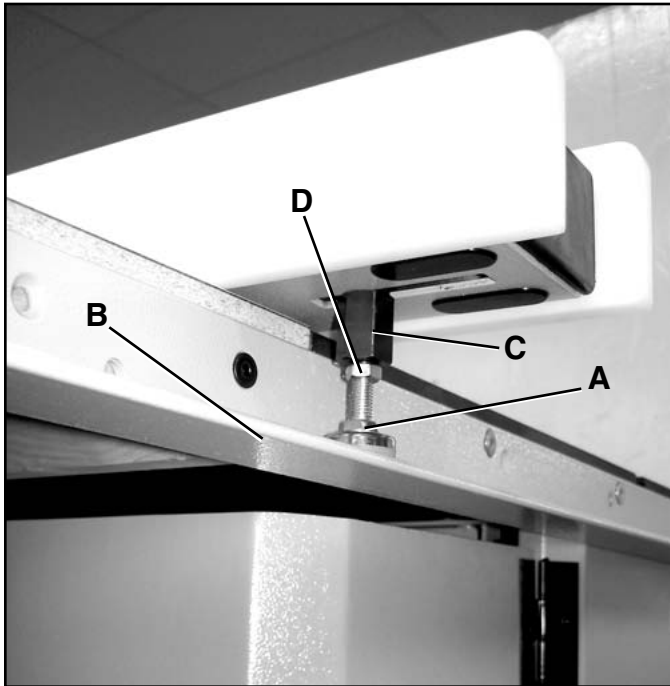

2. If the Rear Foot Assembly does not rest on the Rear Rail, loosen the Block Screw (C) and slide the foot assembly forwards or backwards until the foot rests on the rear rail.
3. Once the placement of the Foot Assembly is complete, re-tighten the Block Screw.

LEVELING THE FENCE TO THE TABLE

1. Unlock the Fence from the Guide Tube.
2. View the Fence from the left side of the saw. The space between the table and the Fence bottom should be equal along the entire length of the Fence.
3. The Rear Foot Assembly (A) on the rear of the fence and the Adjusting Screws (E) on the front of the Fence are used in conjunction to level the Fence. Adjust whichever one is necessary (or both), until the Fence is level with the table. **SEE FIGS. 13 and 14.**
4. Once the Fence is level, tighten Hex Nut (D) to lock the Rear Foot Assembly in place. **SEE FIG. 13.**

Fig. 14

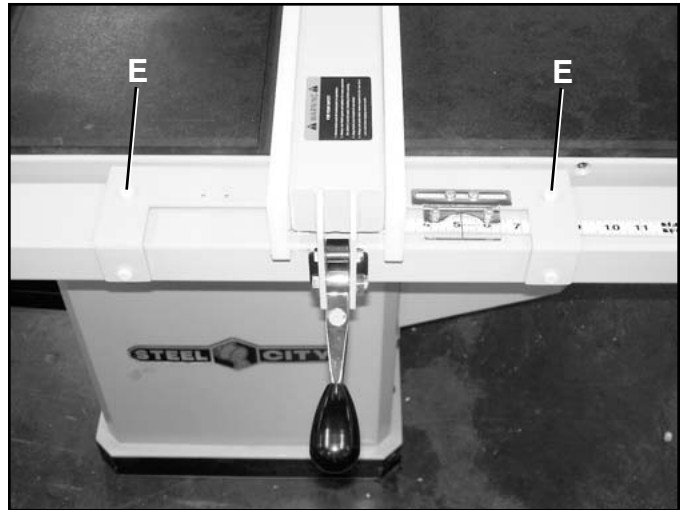

NOTICE: An extra set of Adjusting Screws (E) of a different length is included with your Fence System. Use whichever length works best with your table saw.

SETTING CLAMPING PRESSURE

The Fence has been adjusted at the factory to lock securely when the Lock Handle is pushed down. If an adjustment is needed:

1. Unlock the Fence and remove it from the Guide Tube
2. Adjust the two Adjusting Set Screws (A) **EQUALLY** until the fence is held securely when the lock handle is pushed down. **SEE FIG. 15.**

Fig. 15

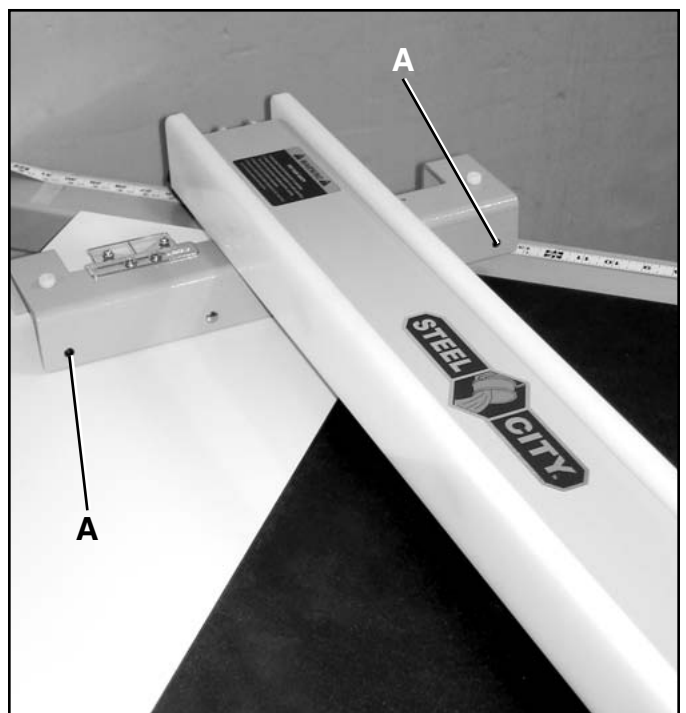

SETTING FENCE PARALLEL

NOTICE: Before aligning the parallelism of the Fence it is **CRUCIAL** that the blade of your saw be parallel with the miter slots in your table top. If you are unsure of how to check or adjust the parallelism of the blade to the miter slots, refer to the User manual of your table saw.

1. Unlock the fence and align the Fence so that the two set screws (A) line up with the two “windows” (B) in the Front Rail. These windows will allow access to the set screws while the fence is still on the Guide Tube. **SEE FIGS. 15 and 16.**

Fig. 16

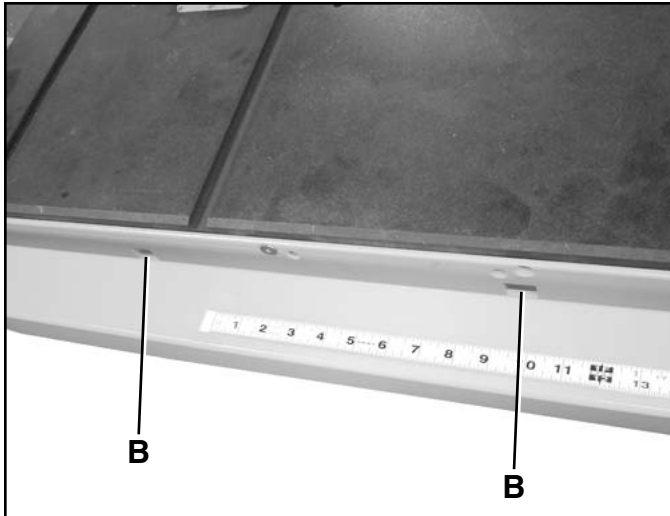

2. Lock the fence down and place a combination square (C) against the right edge of the right miter slot. **SEE FIG. 17.**

Fig. 17

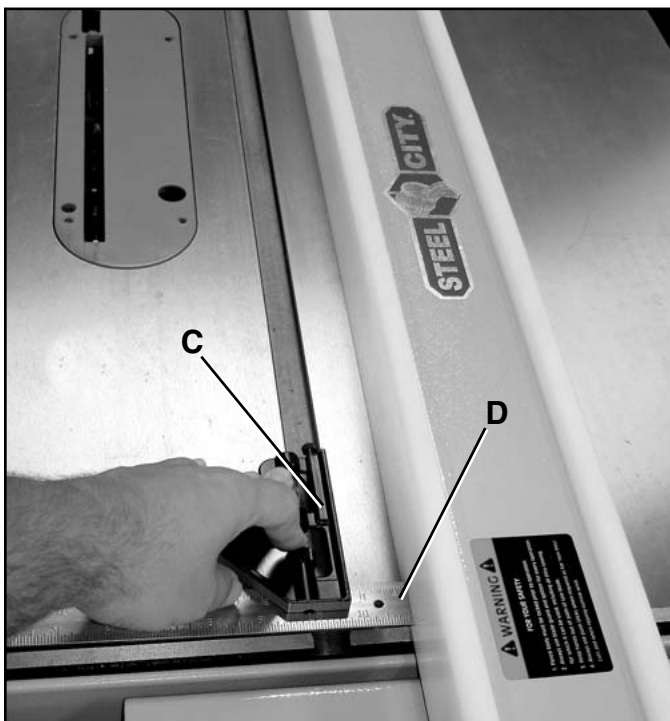

3. Extend the blade (D) of the combination square so that it just touches the left side of the Fence Assembly. Note the measurement.
4. Move the combination square to the rear of the table and retake the measurement from the miter slot to the fence. It should be identical to the measurement taken in step 3. If the measurements are not identical, proceed to step 5.
5. Unlock the fence and adjust one of the set screws using the provided hex wrench. The wrench can be inserted through the back of the window in the front rail. **SEE FIG. 18.**

Fig. 18



6. Lock the fence down and retake the measurements that you took in steps 3 and 4. Repeat steps 5-6 until both measurements are the same.

NOTICE: The Clamping pressure may need to be re-adjusted after aligning the fence parallel

SETTING FENCE PERPENDICULAR

1. Place the Fence anywhere on the tabletop and lock it down
2. Place a square on the table next to the fence and check to see that the fence is at 90 degrees to the table.
3. If an adjustment is necessary, unlock the fence and turn one of the two adjusting set screws (A).
SEE FIG. 19.

Fig. 19

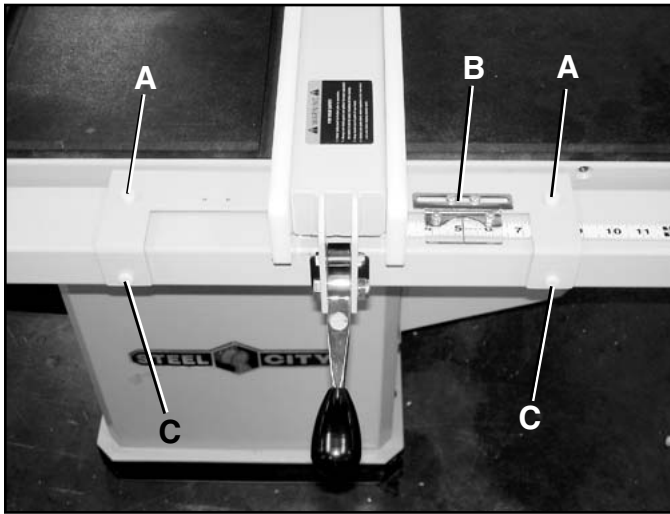

4. Lock the fence down and recheck. Continue this process until the fence is square to the table.

CURSOR ADJUSTMENT

1. Raise the saw blade above the tabletop.
2. Set the fence about 6 inches to the right of the saw blade.
3. Lock the fence down and measure the exact distance between the saw blade and the inside of the fence.
4. Loosen the two Phillips head screws(B) on the cursor and slide the cursor to the left or right until the cursor measurement is equal to the measurement you took in step 3. **SEE FIG. 19.**
5. Retighten the cursor and make a test cut. Measure the cut piece to confirm that the cursor alignment is correct.

NOTICE: This adjustment should be checked whenever a new blade is installed.

RAIL GUIDE ADJUSTMENT

To eliminate excessive play in the Fence as it rides along the Guide Tube, the Fence comes equipped with two adjustment set screws.

1. Unlock the Fence.
2. Pull the fence body towards the front of the table saw.
3. Tighten the two Adjustment Set Screws (C) until they just touch the Guide Tube, then back them off about 1/4 turn. This should set the proper amount of play in the Fence. **SEE FIG. 19.**
4. Slide the Fence to the left and right to make sure that Fence moves smoothly. Readjust if necessary.

PARTS

Fence Assembly

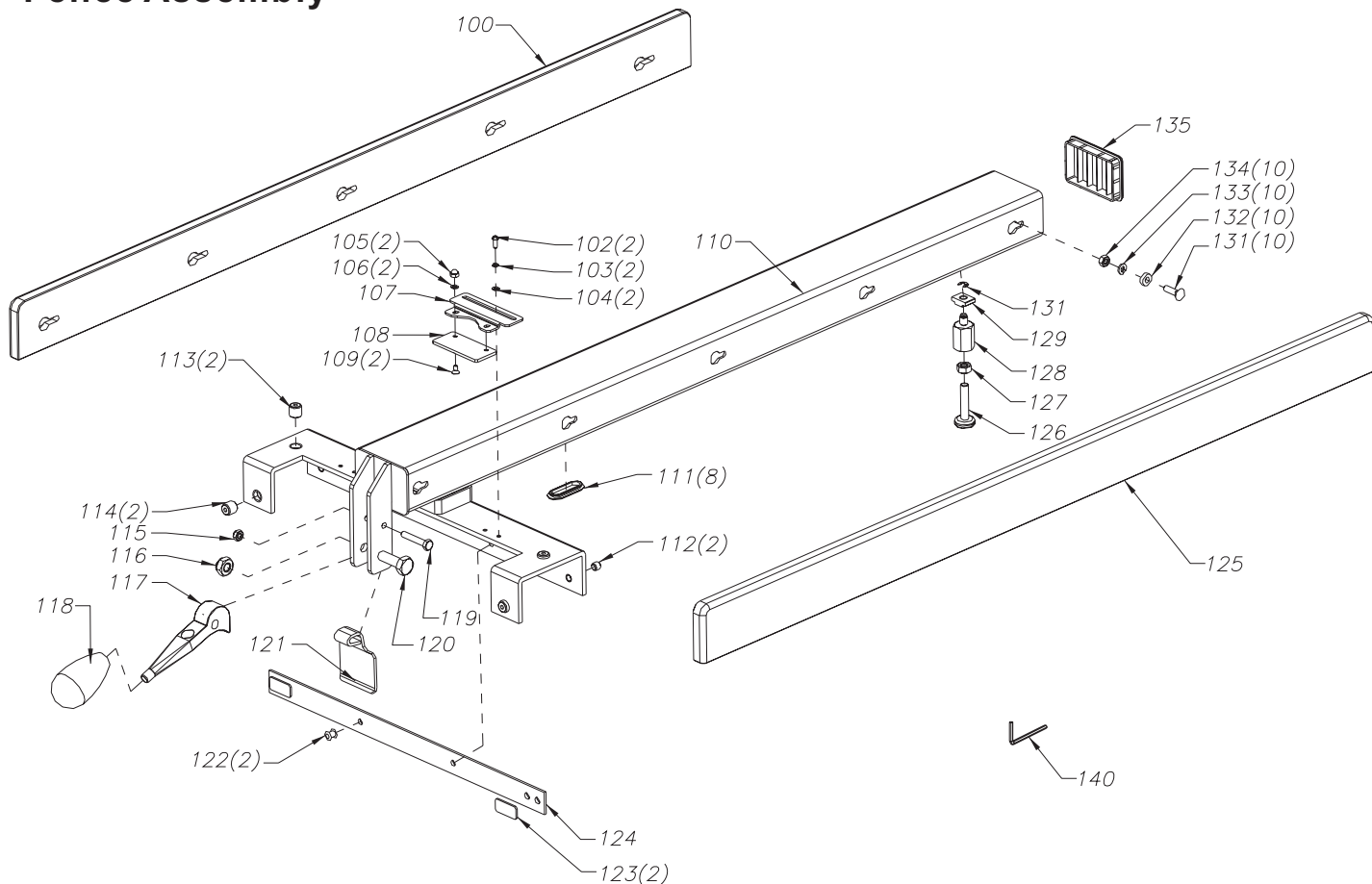

KEY NO.	PART NO.	DESCRIPTION	QTY.
100	OR74222	LEFT SIDE PLATE ASSEMBLY	1
101	OR74218	CURSOR ASSEMBLY (Consists of Ref #s 102-109) -	
102	OR90346	SCR PAN HD M4 x 8mm	2
103	OR90077	WASHER LOCK M4	2
104	OR90079	WASHER FLAT M4	2
105	OR95117	NUT ACORN M4	2
106	OR90431	WASHER EXT TOOTH M4	2
107	OR74220	CURSOR BRACKET	1
108	OR74219	CURSOR	1
109	OR95116	SCR FLAT HD M4 x 8mm	2
110	OR74211	FENCE BODY	1
111	OR74215	HOLE PLUG	8
112	OR90283	SCR HEX SOC SET M8 x 8mm	2
113	OR95114	SCR HEX SOC SET NYLON 1/2-13 x 12mm	2
114	OR95114	SCR HEX SOC SET NYLON 1/2-13 x 12mm	2
115	OR93370	NUT NYLOK M6	1
116	OR95113	NUT NYLOK M10	1
117	OR74213	CAM LOCK HANDLE	1
118	OR74214	KNOB	1
119	OR91750	SCR HEX HD M6 x 35mm	1
120	OR93546	SCR HEX HD M10 x 40mm	1

KEY NO.	PART NO.	DESCRIPTION	QTY.
121	OR74212	LOCK BRACKET	1
122	OR95115	BLIND RIVETS	2
123	OR74217	SLIDE PAD	2
124	OR74216	BRACKET	1
125	OR74221	RIGHT SIDE PLATE ASSEMBLY	1
126	OR74224	FOOT ASSY	1
127	OR90307	NUT HEX M8	1
128	OR95121	BLOCK SCREW	1
129	OR95119	NUT SQUARE M8	1
130	OR95120	E RING ETW-5	1
131	OR95118	SCR CARRIAGE HD M6 x 22mm	10
132	OR74223	SPACER	10
133	OR90502	WASHER LOCK M6	10
134	OR90235	NUT HEX M6	10
135	OR74209	END CAP	1
136	OR95123	SCR HEX SOC SET NYLON 1/2-13 x 20mm (NOT SHOWN)	2
137	OR74227	USER MANUAL (ENGLISH) NOT SHOWN	1
138	OR74228	USER MANUAL (SPANISH) NOT SHOWN	-
139	OR74229	USER MANUAL (FRENCH) NOT SHOWN	-
140	OR90805	HEX WRENCH 4mm	1

Fence and Rails - 30 in.

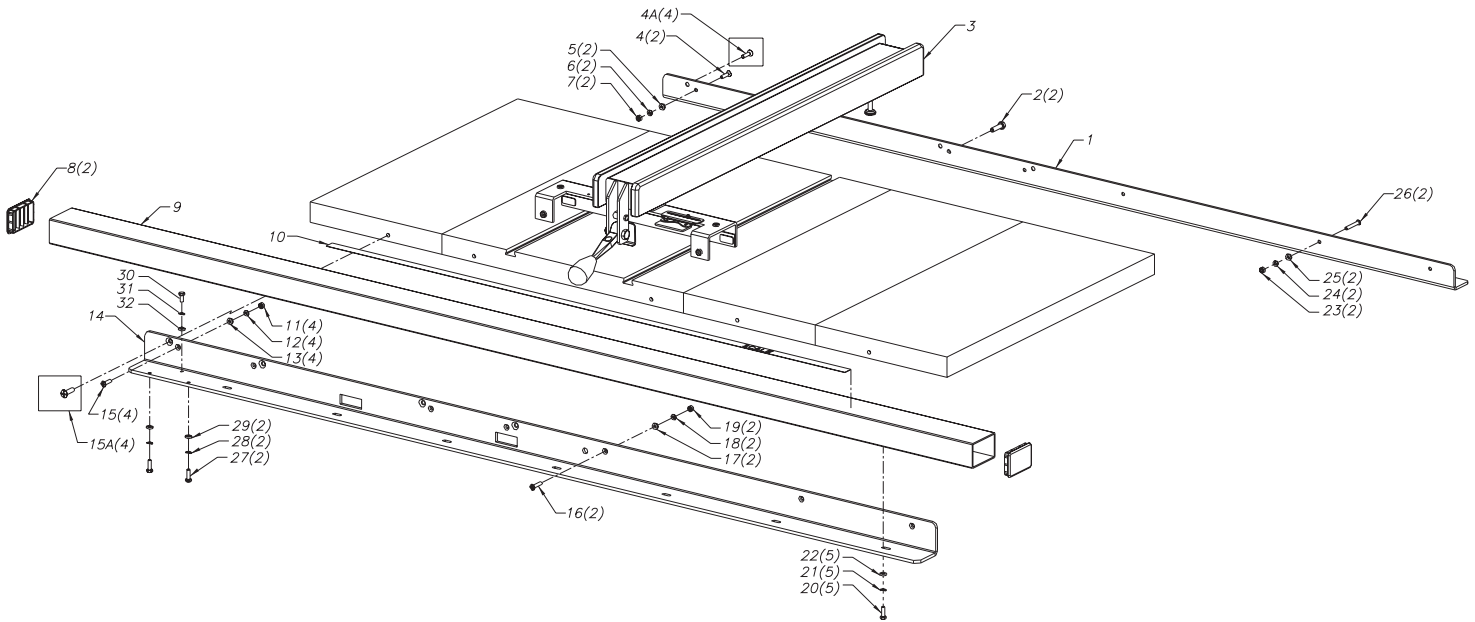

KEY NO.	PART NO.	DESCRIPTION	QTY.	KEY NO.	PART NO.	DESCRIPTION	QTY.
1	OR74233	REAR RAIL 30"	1	16	OR95112	SCR HEX SOC FLAT HD 1/4-20 x 2-1/4"	2
2	OR90634	SCR HEX HD 5/16-18 x 1"	2	17	OR90070	WASHER LOCK 1/4"	2
3	OR74210	FENCE ASSEMBLY	1	18	OR90060	WASHER FLAT 1/4"	2
4	OR95111	SCR HEX SOC FLAT HD 1/4-20 x 1-3/4"	2	19	OR90071	NUT HEX 1/4-20	2
4A	OR95110	SCR HEX SOC FLAT HD 5/16-18 x 1"(SEE NOTE 1)	4	20	OR90176	SCR HEX HD 1/4-20 x 3/4"	5
5	OR90060	WASHER FLAT 1/4"	2	21	OR90070	WASHER LOCK 1/4"	5
6	OR90070	WASHER LOCK 1/4"	2	22	OR90060	WASHER FLAT 1/4"	5
7	OR90071	NUT HEX 1/4-20	2	23	OR90071	NUT HEX 1/4-20	2
8	OR74209	END CAP	2	24	OR90060	WASHER FLAT 1/4"	2
9	OR74235	GUIDE TUBE	1	25	OR90070	WASHER LOCK 1/4"	2
10	OR72604	SCALE	1	26	OR95112	SCR HEX SOC FLAT HD 1/4-20 x 2-1/4"	2
11	OR90071	NUT HEX 1/4-20	4	27	OR90530	SCR HEX HD M6 x 10mm	2
12	OR90070	WASHER LOCK 1/4"	4	28	OR90502	WASHER LOCK M6	2
13	OR90060	WASHER FLAT 1/4"	4	29	OR90744	WASHER FLAT M6	2
14	OR74234	FRONT RAIL 30"	1	30	OR95122	SCR ROUND HD M6 x 10mm	1
15	OR95111	SCR HEX SOC FLAT HD 1/4-20 x 1-3/4"	4	31	OR90502	WASHER LOCK M6	1
15A	OR95110	SCR HEX SOC FLAT HD 5/16-18 x 1"(SEE NOTE 1)	4	32	OR90744	WASHER FLAT M6	1

NOTE 1 : ONLY USE FOR GRANITE TABLE.

Fence and Rails - 50 in.

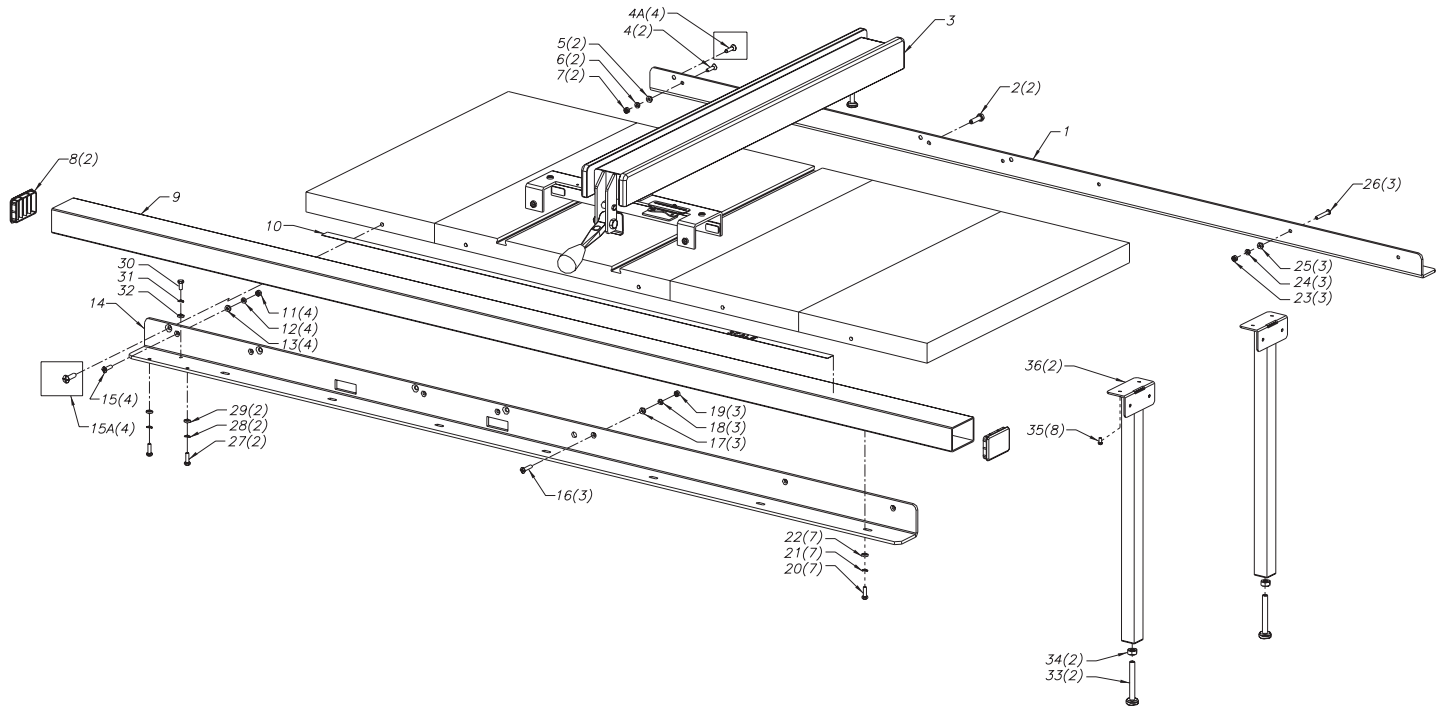

KEY NO.	PART NO.	DESCRIPTION	QTY.	KEY NO.	PART NO.	DESCRIPTION	QTY.
1	OR74237	REAR RAIL 50"	1	18	OR90060	WASHER FLAT 1/4"	3
2	OR90634	SCR HEX HD 5/16-18 x 1"	2	19	OR90071	NUT HEX 1/4-20	3
3	OR74210	FENCE ASSEMBLY	1	20	OR90176	SCR HEX HD 1/4-20 x 3/4"	7
4	OR95111	SCR HEX SOC FLAT HD 1/4-20 x 1-3/4"	2	21	OR90070	WASHER LOCK 1/4"	7
4A	OR95110	SCR HEX SOC FLAT HD 5/16-18 x 1"(SEE NOTE 1)	4	22	OR90060	WASHER FLAT 1/4"	7
5	OR90060	WASHER FLAT 1/4"	2	23	OR90071	NUT HEX 1/4-20	3
6	OR90070	WASHER LOCK 1/4"	2	24	OR90060	WASHER FLAT 1/4"	3
7	OR90071	NUT HEX 1/4-20	2	25	OR90070	WASHER LOCK 1/4"	3
8	OR74209	END CAP	2	26	OR95112	SCR HEX SOC FLAT HD 1/4-20 x 2-1/4"	3
9	OR74208	GUIDE TUBE	1	27	OR90530	SCR HEX HD M6 x 10mm	2
10	OR70591	SCALE	1	28	OR90502	WASHER LOCK M6	2
11	OR90071	NUT HEX 1/4-20	4	29	OR90744	WASHER FLAT M6	2
12	OR90070	WASHER LOCK 1/4"	4	30	OR95122	SCR ROUND HD M6 x 10mm	1
13	OR90060	WASHER FLAT 1/4"	4	31	OR90502	WASHER LOCK M6	1
14	OR74207	FRONT RAIL 50"	1	32	OR90744	WASHER FLAT M6	1
15	OR95111	SCR HEX SOC FLAT HD 1/4-20 x 1-3/4"	4	33	OR74226	FOOT ASSY	2
15A	OR95110	SCR HEX SOC FLAT HD 5/16-18 x 1"(SEE NOTE 1)	4	34	OR90228	NUT HEX M10	2
16	OR95112	SCR HEX SOC FLAT HD 1/4-20 x 2-1/4"	3	35	OR93864	SCR SELF TAPPING M5 x 15mm	8
17	OR90070	WASHER LOCK 1/4"	3	36	OR74225	FENCE LEG ASSY	2

NOTE 1 : ONLY USE FOR GRANITE TABLE.

◆ NOTES ◆

◆ NOTES ◆

◆ NOTES ◆



STEEL CITY TOOL WORKS

www.steelcitytoolworks.com

1-877-SC4-TOOL

(1-877-724-8665)

5 Year Warranty

